

# TECHNICAL DATA 35B



<b>Volume of air:</b>		
Normal speed	126 m <sup>3</sup> /h (35 l/s)	
Forced flow	216 m <sup>3</sup> /h (60 l/s)	
<b>Preheating:</b>		
Electric preheating	750 W, PTC	
<b>Electric data:</b>		
Heating	230V, 1-phase 10 A	
Supply air fan	83 W, 0.4 A	
Exhaust air fan	83 W, 0.4 A	
<b>Heat recovery:</b>		
Counter flow heat exchanger Recovery > 80%.		
<b>Sound levels:</b>		
35 dB(A) 126 m <sup>3</sup> /h (35 l/s) 40 dB(A) 216 m <sup>3</sup> /h (60 l/s)		
<b>Duct connection:</b>		
Spiro duct Ø 160 on supply air and Ø 125 exhaust air connection.		
<b>Color:</b>		
White powder coating.		
<b>Dimensions:</b>		
Unit	Height	910 mm
	Width	600 mm
	Depth	285 mm incl door
Door, removable at site transport	Depth	22 mm
Unit without door	Depth	263 mm

## KUBEN 35B

- \* *Extremely low sound level because of the low internal pressure loss, good aerodynamic and technical developed sound insulation.*
- \* *High efficiency heat recovery > 80%.*
- \* *Very compact unit designed to be placed indoors. Installed on the wall.*
- \* *Easy and quick installation.*
- \* *Turnkey with built-in control. Just connect to the power supply.*
- \* *Many choices of extra equipment and accessories.*

### ADDITIONAL HEAT

Afterheating: electric heater 750 W.  
Temperature control with thermostat control.  
Over heating protection for the electric battery.  
Supply air temperature control.

### STANDARD EQUIPMENT

Direct driven, energy efficient EC-fans.  
Counter flow heat exchanger.  
Thermal efficiency > 80%.  
Completely sealed with no transference between supply air and exhaust air.  
Filter F7. Pocket filter with very good filter economy.

### OPTIONAL

Mirror-inverted design.  
Timer for high fan speed or additional operating time.  
Presence detector for start/stop.  
External alarm panel. A- and B-alarm.  
Duct kit. Complete kit with white painted ducts, bendable pipes and components for a complete installation.  
Units and accessories in any color.  
Automatic defrosting function.  
Electric after heating.  
Stepless speed regulation.  
Supply air temperature control with setting on the panel.  
Built-in electrical- and regulation central.

# DUCT CONNECTION, DIMENSIONS

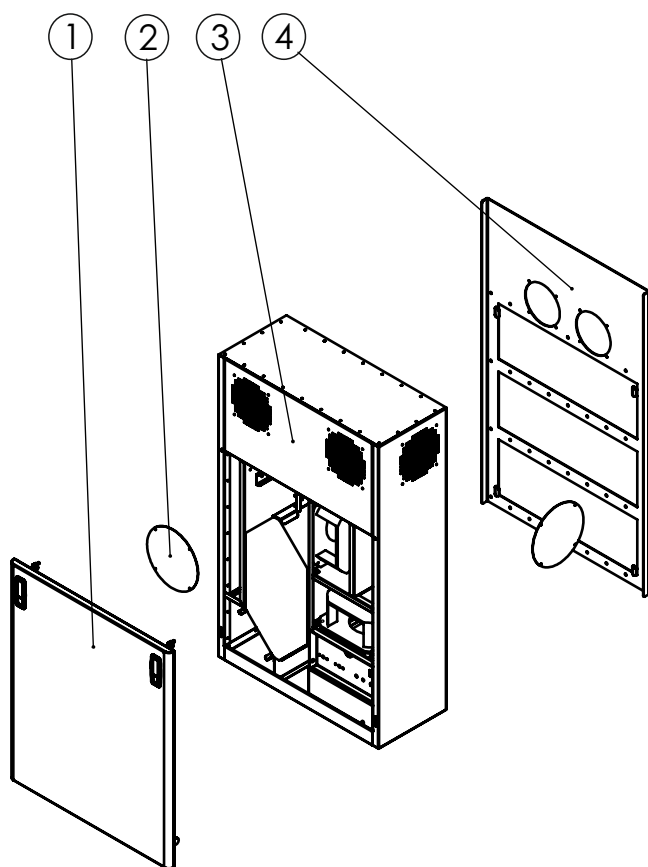

## FUNCTION

Kuben 35 is intended to very quietly ventilate a room, a small apartment, an office or similar.

The unit is very energy-efficient, with counter-current heat exchangers and high efficiency energy efficient EC fans, is placed inside the outer wall.

Supply air (freshly heated air from the unit into the premises), blown into the top or connected with a 125 duct and is drawn into clean rooms, bedrooms, living rooms, offices, etc.

Exhaust air (consumed hot air from the premises into the unit) is connected with 125 duct from WC, shower, kitchenette, etc.

Outdoor air (fresh cold air from the outside) is connected with a 125 duct from, for example, a combi device to the outer wall to the connection marked "outdoor air" on back of the unit.

Exhaust air (exhausted air, without heat content, from the unit into the free) is connected on the back of the unit with 125 ducts drawn to a combi device on the outer wall.

## WALL MONTING FRAME

The assembly comes with a mounting frame that facilitates and speeds up the assembly. The mounting frame is easily attached to the inside of the outer wall and the holes for exhaust and outdoor air are marked on the wall. Then the frame is taken down and holes is performed. The mounting frame is then permanently screwed into place and the unit is then hooked onto the frames fastening hooks. Done!

- ① Service hatch
- ② Cover for selecting supply air or exhaust air holes.
- ③ Unit section
- ④ Wall mounting frame

## DIMENSIONS

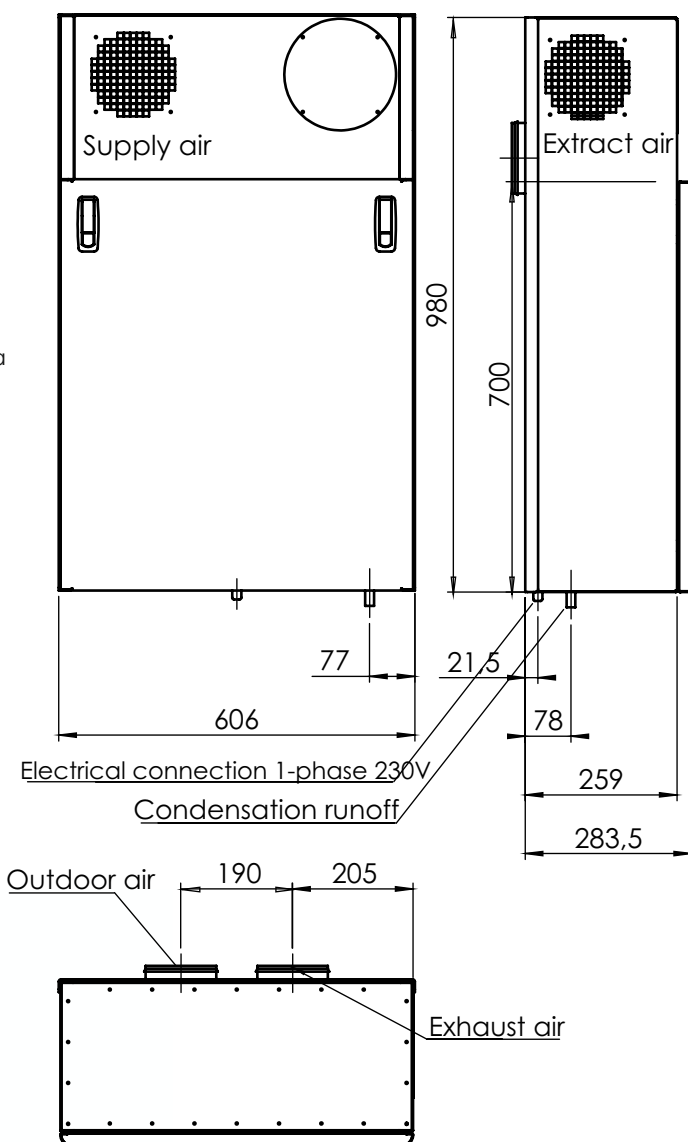

The unit can be specially ordered in mirror-mounted version.